

ECP No:	ICE_ECP_009	ECP Version:	V1.0, 20/06/2012
ECP Name:	SSFL Train Control Boundaries Sefton Park Junction to Leightonfield		
ECP Author:	Mark Wood, ARTC NTCS Project Manager		
Change Classification	Minor Change – Update to existing ICE GIS Configuration data only, no ICE software changes required.		
Area of Impact:	Changes impact operations in the NCCS & RMC. All ICE units will automatically download a configuration update upon reboot for changes to global parameters.		
Change Summary:	The train control boundary change the area to be transferred to ARTC control (20.5km Sefton Park Jct to 24.5km Leightonfield Yard, 22.5km Bankstown line to 23km Bankstown line and 21km Enfield West) identifies the SSFL shared corridor area of control		
ECP Reviewers:	James Allenby, ARTC Project Manager Telecommunications		
ECP Approval:	John Hall, NTCS CCB Chairperson & ARTC Communications Manager Signed: <i>[Signature]</i> Date: 20 th June 2012.		

Test & Implementation Plan	
Test & Implementation Plan	<ol style="list-style-type: none"> 1. Implementation is scheduled for 11:00 – 12:00 Friday 22nd June 2012. 2. Perform configuration updates in ICE GIS 3. ICE Rack Testing using GPS Simulator on ARTC10 <ul style="list-style-type: none"> • Confirm ICE changeover for NCCS (JUNEE) at the new interface boundary. 4. Operational ICE units will download the update on next reboot.

ECP CHANGE DETAIL

Change Background:

The train control boundary change the area to be transferred to ARTC control (20.5km Sefton Park Jct to 24.5km Leightonfield Yard, 22.5km Bankstown line to 23km Bankstown line and 21km Enfield West) identifies the SSFL shared corridor area of control.

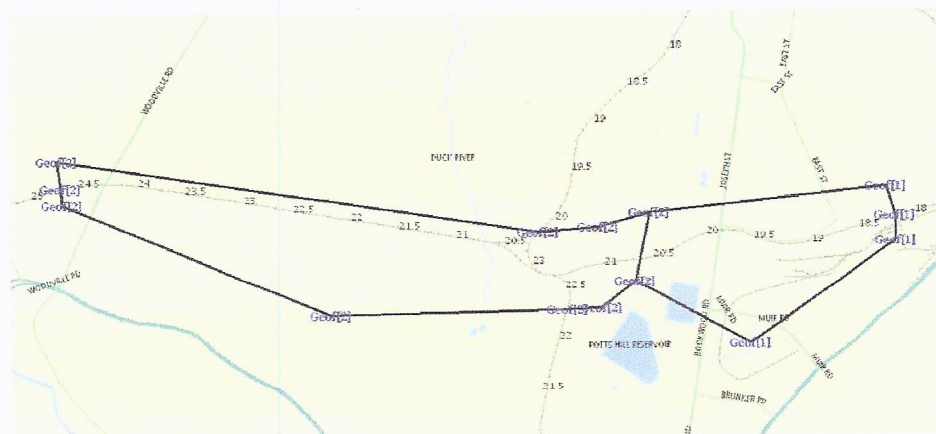

Figure 1: Enfield West – Sefton and Sefton - Leightonfield ARTC ICE Geofence areas

Changes Required:

Edit the iceGIS train control geo fences to align with the new train control boundaries:

1. In ICEGIS for Train Control Centre NCCS, remove existing geo-fence and replace with new geo-fence
2. Save changes in ICE GIS

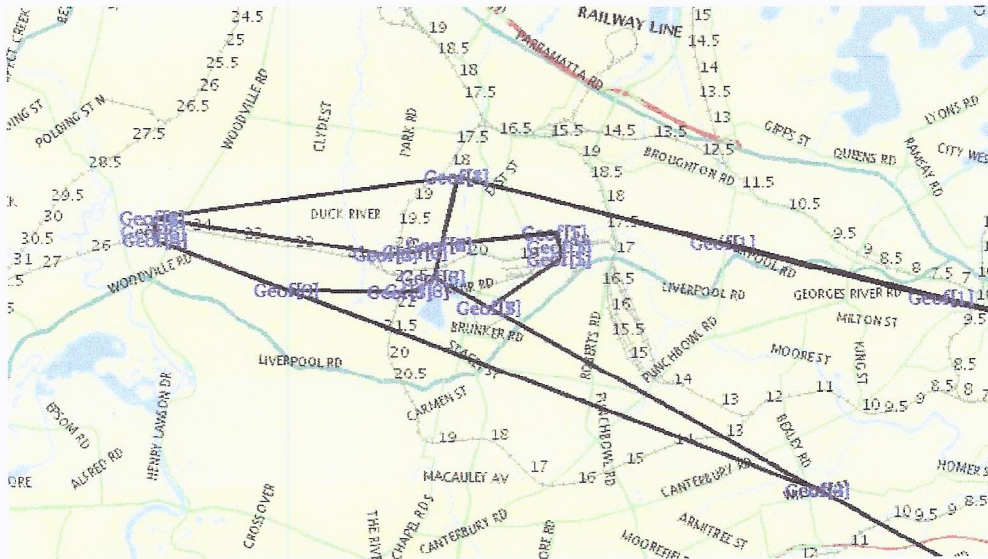

Figure 2: New Combined RailCorp – ARTC SSFL ICE Geofence Definition

Once the changes have been saved in ICE GIS each ICE unit on next reboot will automatically download a configuration update containing the updated geo-fence configuration.

For further information please refer to Safe Notice 2012 Number 2 - 1709